

**TYPE F**  
**MOD. F-7-13**

**SEGNALATORE DA PANNELLO PER FORO Ø 13mm CONNESSIONE FASTON**  
**SIGNAL LAMP FOR PANEL AND HOLE Ø 13mm. CONNECTION BY TAB**

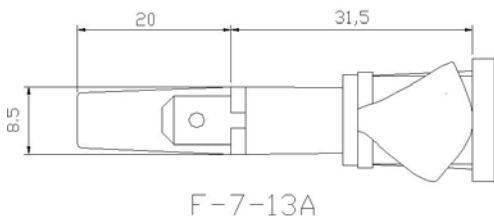

<p><b>TENSIONE</b> Da 2V a 400V <b>LAMPADA</b> neon; fluoro; incandescenza; LED <b>TEMPERATURA</b> 120°C, 150°C.</p> <p><b>TERMINALI</b> Faston maschio 6,3x0,8 o 4,8x0,8</p> <p><b>APPROVAZIONI</b> UL-CSA – VDE - CE</p>	<p><b>VOLTAGE</b> From 2V to 400V <b>LAMP</b> Neon; fluorescent; incandescence; LED <b>TEMPERATURE</b> 120°C, 150°C.</p> <p><b>TERMINALS</b> Tab 6,3x0,8 or 4,8x0,8</p> <p><b>APPROVALS</b> UL-CSA – VDE - CE</p>
--	---

- Questo segnalatore può essere fornito con gemma montata o separata e con cavetteria aggiuntiva.**  
**-This signal lamp can be supplied with lens mounted or separated and with additional wires**

**LENTI**  
**LENSES**

